

CLUTCH UNIT REMOVAL/INSTALLATION

B3E051016000W01

1. Remove in the order indicated in the table.
2. Install in the reverse order of removal.

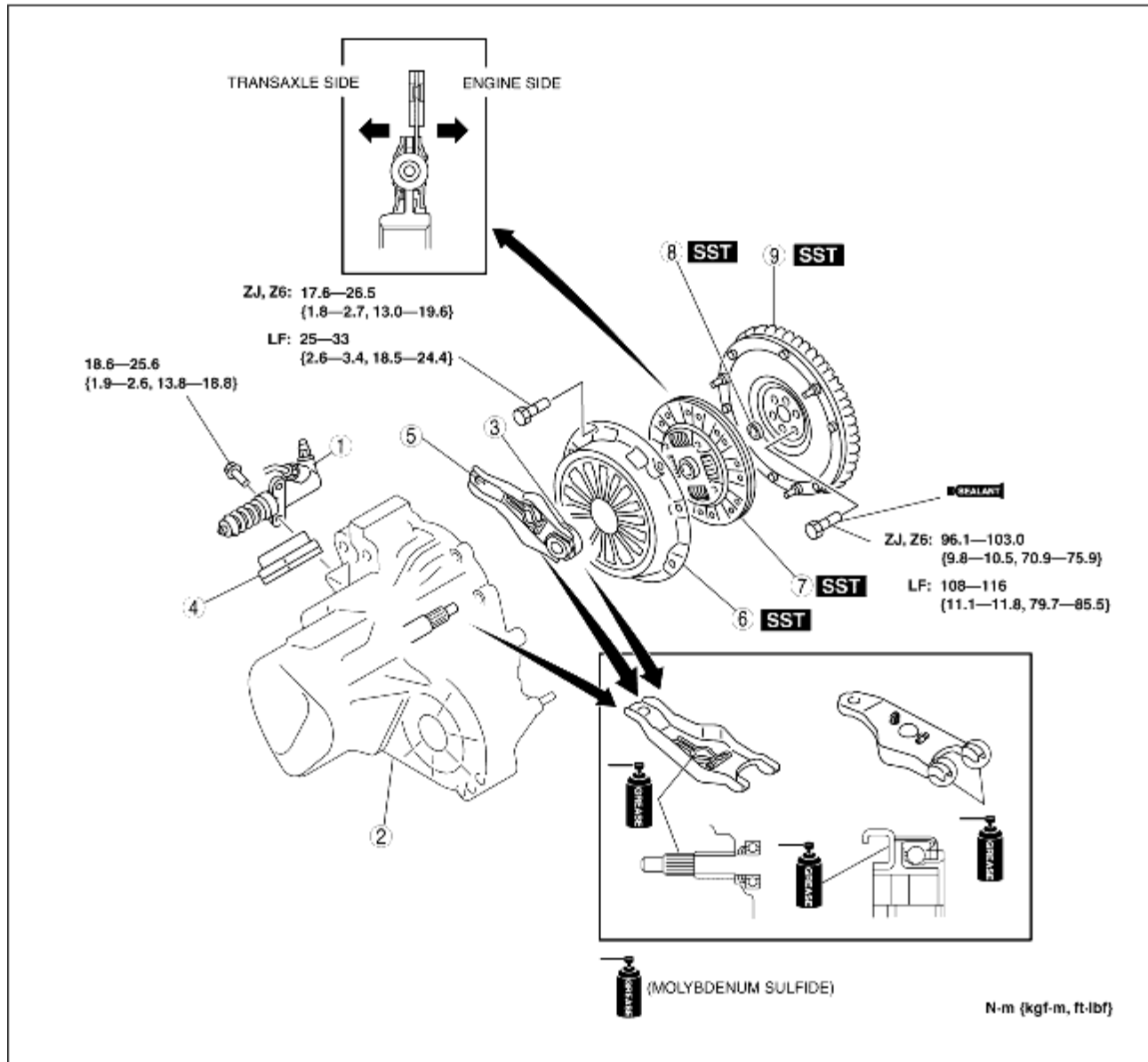

B3E0510W050

1	Clutch release cylinder (See CLUTCH RELEASE CYLINDER REMOVAL/INSTALLATION.)
2	Manual transaxle (See MANUAL TRANSAXLE REMOVAL/INSTALLATION [F35M-R].) (See MANUAL TRANSAXLE REMOVAL/INSTALLATION [G35M-R].)
3	Clutch release collar (See CLUTCH RELEASE COLLAR INSPECTION.)

4	Boot
5	Clutch release fork (See Clutch Release Fork Removal Note.)
6	Clutch cover (See Clutch Cover and Disc Removal Note.) (See Clutch Cover Installation Note.)
7	Clutch disc (See Clutch Cover and Disc Removal Note.) (See Clutch Disc Installation Note.)
8	Pilot bearing (See Pilot Bearing Removal Note.) (See Pilot Bearing Installation Note.)
9	Flywheel (See Flywheel Removal Note.) (See Flywheel Installation Note.)

Clutch Release Fork Removal Note

1. Remove the fork supporter before disassembling the release fork.

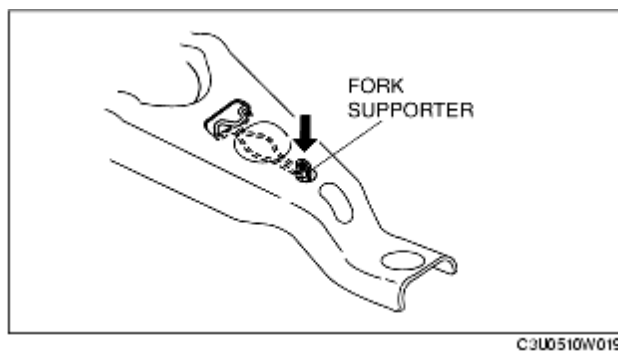

Clutch Cover and Disc Removal Note

1. Install the **SSTs**.
2. Loosen each bolt one turn at a time in a crisscross pattern until spring tension is released.
3. Remove the clutch cover and disc.

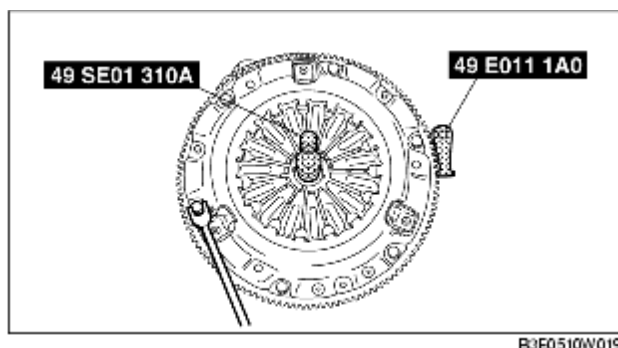

Pilot Bearing Removal Note

Note

- The pilot bearing does not need to be removed unless you are replacing it.

1. Use the **SST** to remove the pilot bearing.

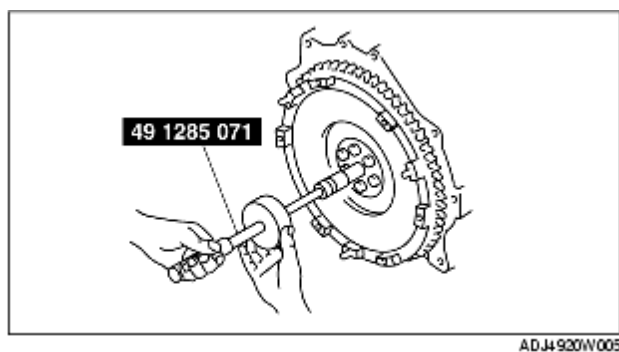

Pilot Bearing Installation Note

1. Use the **SSTs** to install the pilot bearing.

ZJ, Z6

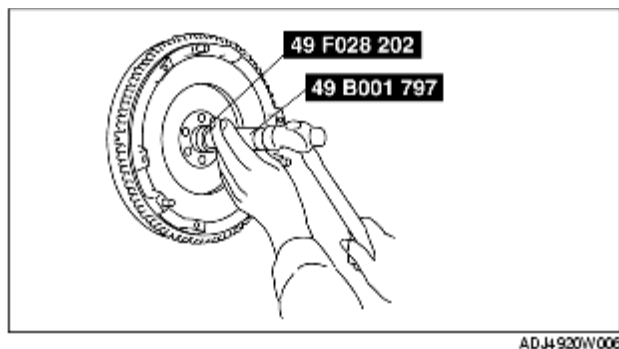

LF

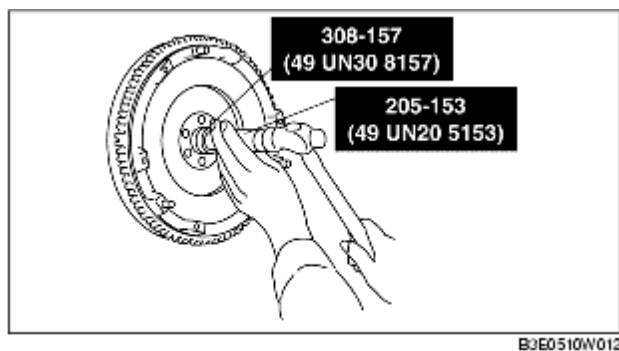

Flywheel Removal Note

1. Hold the flywheel using the **SST**.
2. Remove the bolts evenly and gradually in a crisscross pattern.
3. Remove the flywheel.

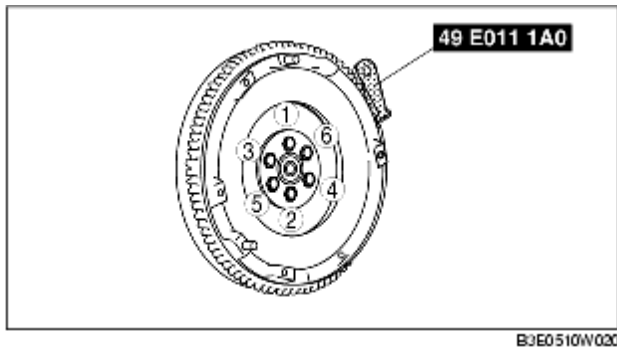

4. Inspect for oil leakage from the crankshaft rear oil seal.

- If there is any malfunction, replace the crankshaft rear oil seal.
(See [REAR OIL SEAL REPLACEMENT \[ZJ, Z6\]](#).)
(See [REAR OIL SEAL REPLACEMENT \[LF\]](#).)

Flywheel Installation Note

1. Install the flywheel to the crankshaft.
2. When reusing the bolts, clean threads and hole, then apply locking compound to the threads.

Note

- No locking compound is needed when using new bolts.

3. Hand-tighten the flywheel lock bolts.
4. Install the **SST** to the flywheel.

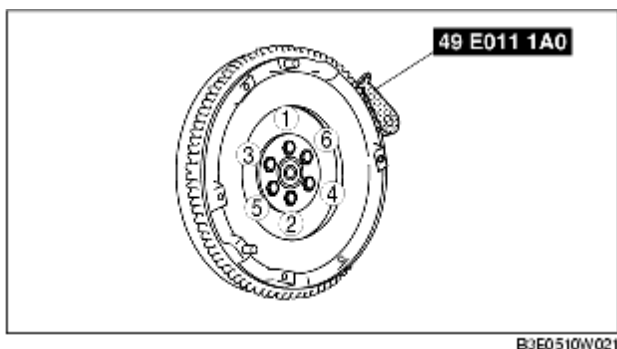

5. Gradually tighten the flywheel lock bolts in a crisscross pattern.

Tightening torque
ZJ, Z6: 96.1-103.0 N·m
{9.8-10.5 kgf·m, 70.9-75.9 ft·lbf}

LF: 108-116 N·m
{11.1-11.8 kgf·m, 79.7-85.5 ft·lbf}

Clutch Disc Installation Note

1. Hold the clutch disc position using the **SST**.

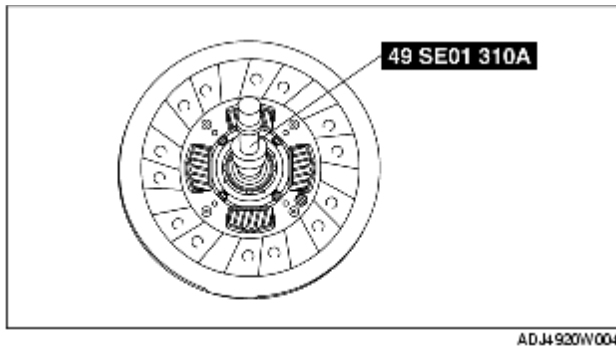

Clutch Cover Installation Note

1. Install the **SSTs**.
2. Tighten the bolts evenly and gradually in a crisscross pattern.

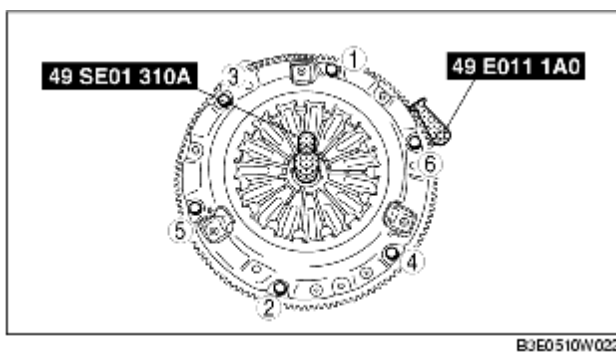

Tightening torque
ZJ, Z6: 17.6-26.5 N·m
{1.8-2.7 kgf·m, 13.0-19.6 ft·lbf}
LF: 25.0-33.0 N·m
{2.6-3.4 kgf·m, 18.5-24.4 ft·lbf}